

Fixing the plates to the cabinet sides

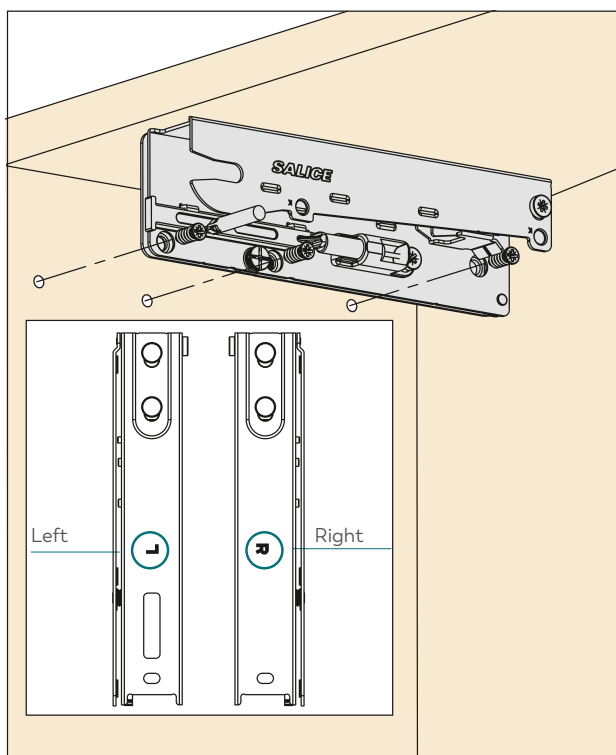

Fixing the cups to the door

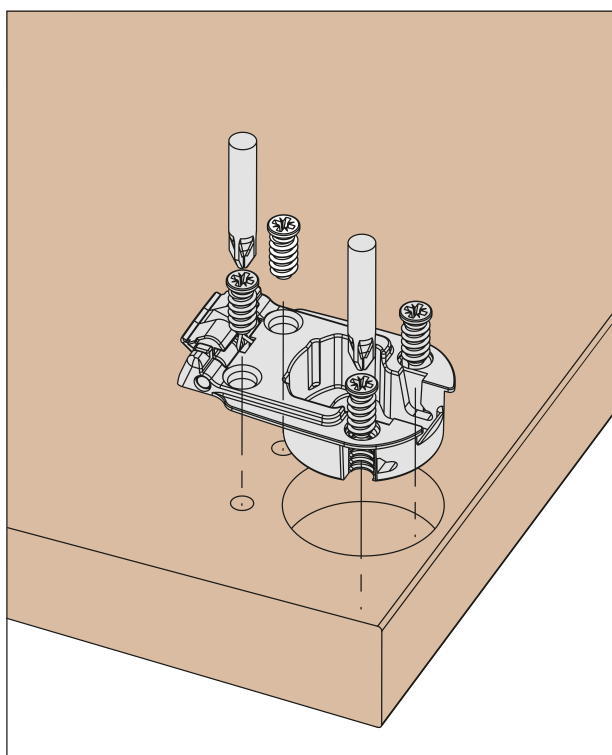

Deploying the system to the cups

- This operation is tool free

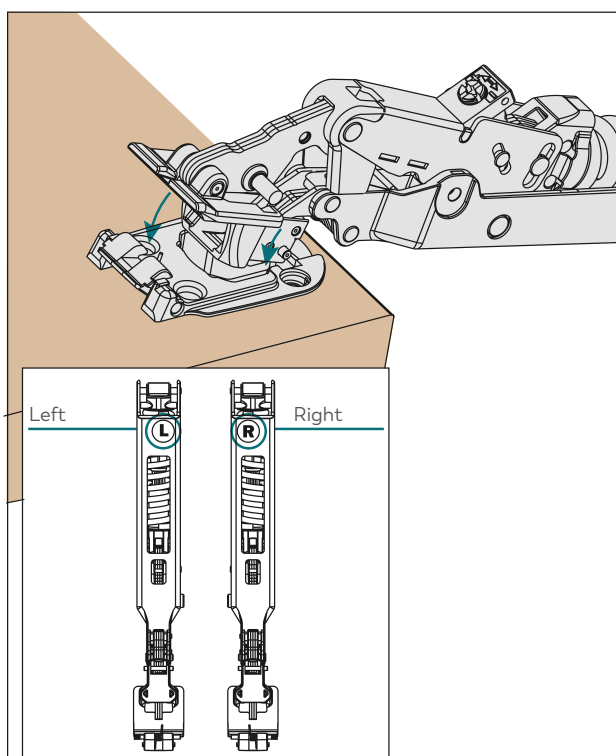

Installing the system to the plates.

- Insert the system until back fixing is engaged.
- This operation is tool free.

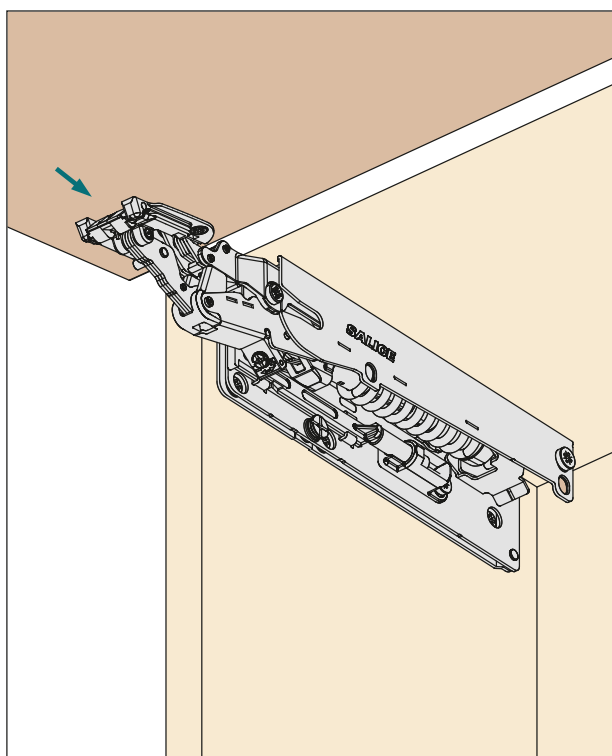

## Installing the covers

**WARNING! Security cable ties.**

Remove the cable ties only at the end of the assembly. Use the instructions and the QR Code attached to the systems.

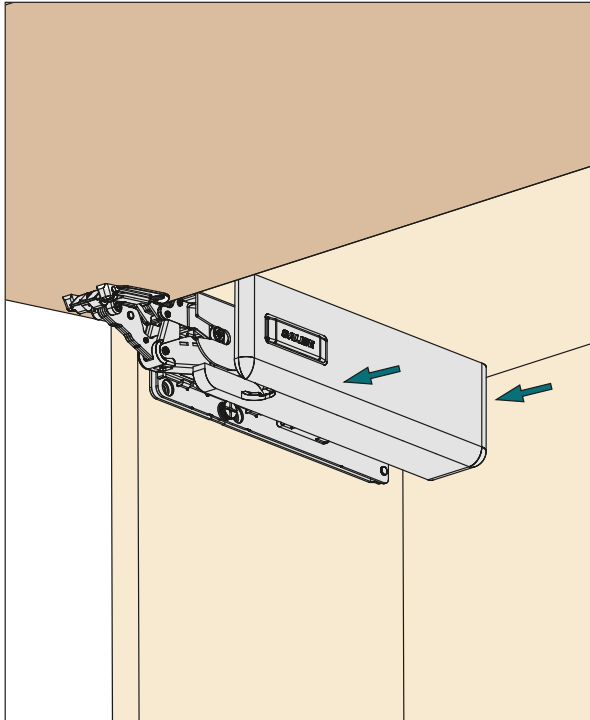

## Adjustments

1. Adjustment of the spring strength.
2. Adjustment of the decelerating effect.
3. Extension/adjustment of the opening angle of the door.
4. Height adjustment of the door from - 2 to +2.
5. Sideways adjustment of the door from - 2 to +2.
6. Depth adjustment of the door from - 1 to +3.

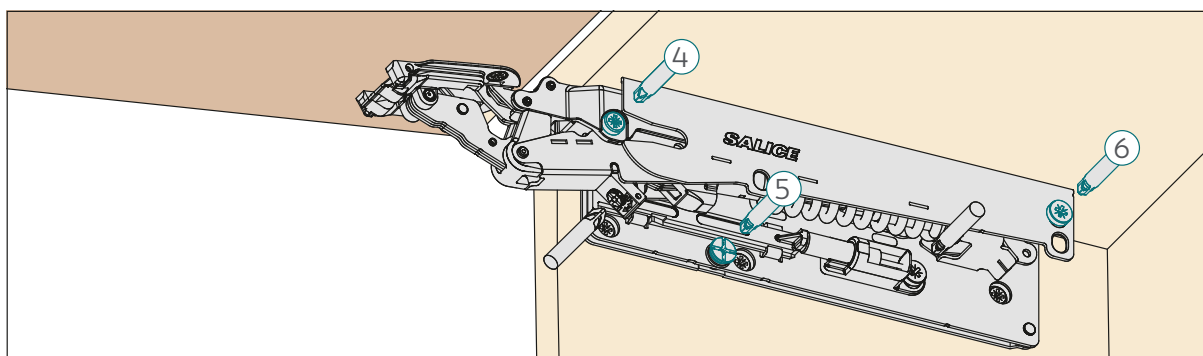
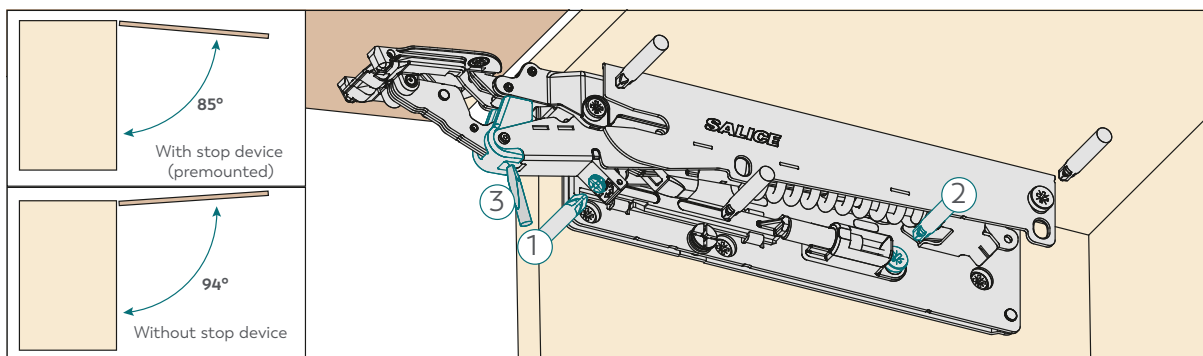

#### Removal of the covers

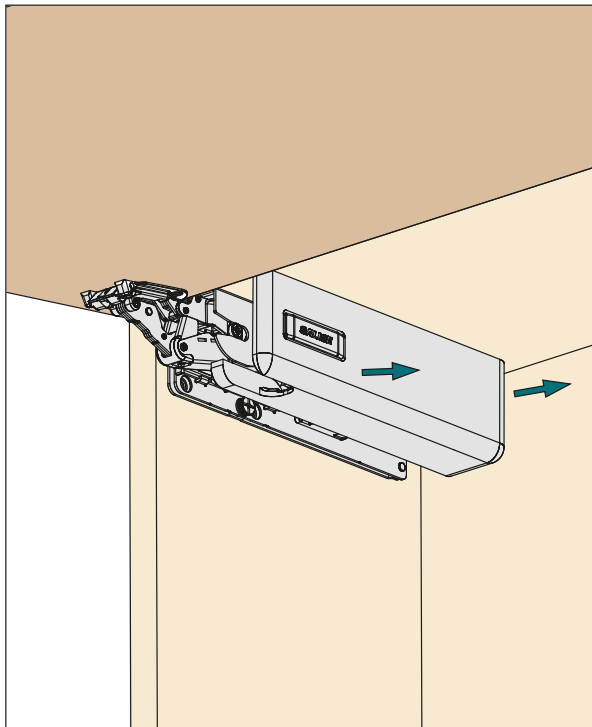

#### Disassembly of the system.

- Press the back lever and pull out the system.
- This operation is tool free.

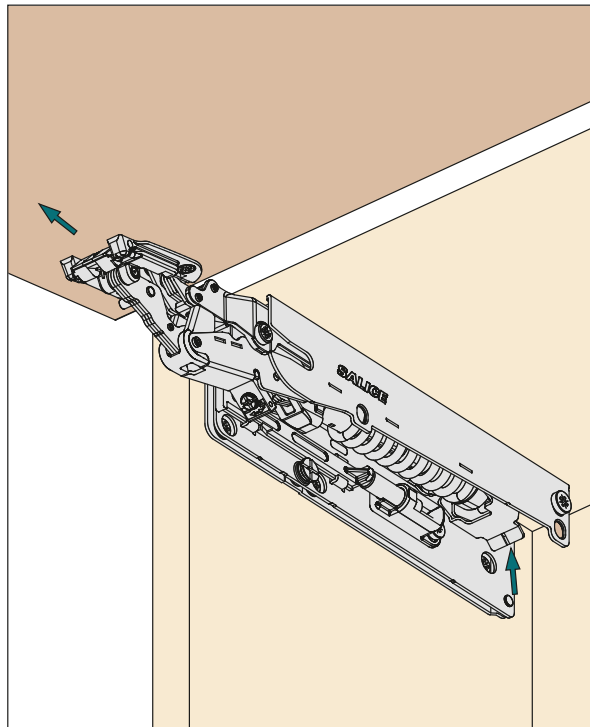

#### Unfasten the system from the cups.

- Disconnecting the system from the cups.
- This operation is tool free.

